

Stub Tube Connector

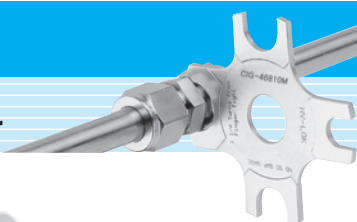

Installation Instruction Port Connectors

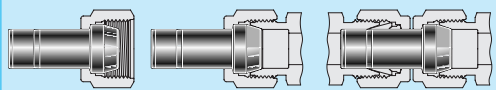

Fig.1 Fig.2 (1/4 turn) Fig.3 (1 1/4 turn)

Machined Ferrule End

While holding fitting body steady, tighten the port connector one-quarter turn from the finger-tight position. For 1/16", 1/8", and 3/16", ; 2mm 3mm and 4mm tube fittings, tighten the port connector one-eighth turn. For over 1in. and over 25mm tube fittings, tighten the port connector one quarter turn.

Reassembly

You may disassemble and reassemble Hy-Lok port connectors many times. Make subsequent connections by slightly tightening with a wrench after snugging the nut by hand.

Tube adapter End

- 1.Insert the tube adapter into the Hy-Lok two ferrule tube fittings until tubing end is firmly seated on the body shoulder and make sure the nut is hand tight.(Fig.3)
- 2.Mark the nut at 9 o'clock position for identification of starting point.
- 3.Tighten the nut 1 1/4turns* with a wrench keeping the fitting body steady with a back-up wrench, when the nut is tightened 1 1/4 turns, the mark at 9o'clock position before tightening will be at 12o'clock position.

Note* : Only 3/4 turn from finger tight is required for 1/16",1/8",3/16"2mm,3mm,and 4mm sizes.

Reassembly

See Hy-Lok two ferrule tube fittings reassembly, page71

Port Connector CPC

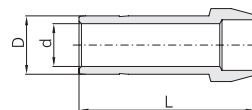

Connects Two Fractional Hy-Lok Ports

Part No.	Tube O.D. D		d Min.	L
	in	mm		
CPC - 1	1/16	1,58	0,76	13,72
CPC - 2	1/8	3,17	2,03	22,35
CPC - 4	1/4	6,35	4,32	24,89
CPC - 5	5/16	7,93	5,59	25,91
CPC - 6	3/8	9,52	6,86	26,67
CPC - 8	1/2	12,70	9,40	36,32
CPC - 12	3/4	19,05	14,73	37,85
CPC - 16	1	25,40	20,32	49,28

Connects Two Metric Hy-Lok Ports

Part No.	Tube O.D. D	d Min.	L
CPC - 3M	3	1,9	22,20
CPC - 4M	4	2,2	23,21
CPC - 6M	6	4,1	25,00
CPC - 8M	8	5,6	26,00
CPC - 10M	10	7,1	27,10
CPC - 12M	12	8,8	36,20
CPC - 15M	15	11,2	37,80
CPC - 16M	16	12,0	37,80
CPC - 18M	18	13,9	37,80
CPC - 20M	20	15,5	39,40
CPC - 22M	22	16,1	38,97
CPC - 25M	25	19,9	49,30
CPC - 28M	28	22,5	63,50
CPC - 32M	32	26,5	69,70
CPC - 38M	38	31,6	81,90

Reducing Port Connector CPR

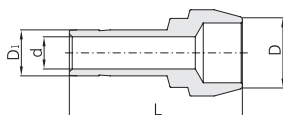

Connects Two Fractional Hy-Lok Ports

Part No.	Tube O.D. D		Reduced O.D. D ₁		d Min.	L
	in	mm	in	mm		
CPR 2 - 1	1/8	3,17	1/16	1,58	0,76	18,30
CPR 4 - 1	1/4	6,35	1/16	1,58	0,76	19,05
CPR 4 - 2	1/4	6,35	1/8	3,17	2,03	22,86
CPR 6 - 2	3/8	9,52	1/8	3,17	2,03	23,37
CPR 6 - 4	3/8	9,52	1/4	6,35	4,32	25,40
CPR 8 - 4	1/2	12,70	1/4	6,35	4,32	29,72
CPR 8 - 6	1/2	12,70	3/8	9,52	6,86	30,73
CPR 12 - 8	3/4	19,05	1/2	12,70	9,40	37,85
CPR 16 - 8	1	25,40	1/2	12,70	9,40	42,93
CPR 16 - 12	1	25,40	3/4	19,05	14,73	43,69

Connects Two Metric Hy-Lok Ports

Part No.	Tube O.D. D	Reduced O.D. D ₁	d Min.	L
CPR 6M - 3M	6	3	1,9	22,90
CPR 8M - 6M	8	6	4,1	25,40
CPR 10M - 6M	10	6	4,1	25,80
CPR 10M - 8M	10	8	5,6	26,30
CPR 12M - 6M	12	6	4,1	29,60
CPR 12M - 8M	12	8	5,6	30,10
CPR 12M - 10M	12	10	7,1	30,60
CPR 16M - 6M	16	6	4,1	29,37
CPR 16M - 12M	16	12	8,8	37,50
CPR 28M - 25M	28	25	19,9	56,50
CPR 32M - 25M	32	25	19,9	60,30
CPR 38M - 25M	38	25	19,9	65,80

All dimensions are in millimeters unless otherwise specified. Dimensions are for reference only, subject to change.