

# Hy-Lok Two Ferrule Tube Fittings

## Male Run Tee CRTM

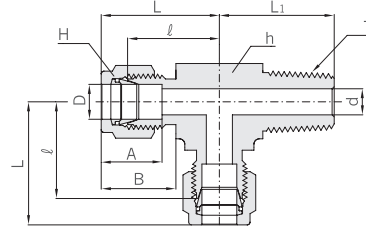

### Connects Fractional Tube To Female NPT Thread

| Part No.    | Tube O.D.<br>D |       | T*<br>(NPT) | d<br>Min. | Width across flat |       |       |       | A     | B     | ℓ     | L     | L <sub>1</sub> |
|-------------|----------------|-------|-------------|-----------|-------------------|-------|-------|-------|-------|-------|-------|-------|----------------|
|             | in             | mm    |             |           | h                 |       | H     |       |       |       |       |       |                |
|             |                |       |             |           | in                | mm    | in    | mm    |       |       |       |       |                |
| CRTM 2 - 2N | 1/8            | 3.17  | 1/8         | 2.28      | 1/2               | 12.70 | 7/16  | 11.11 | 12.70 | 15.24 | 17.00 | 24.91 | 17.80          |
| CRTM 2 - 4N | 1/8            | 3.17  | 1/4         | 2.28      | 1/2               | 12.70 | 7/16  | 11.11 | 12.70 | 15.24 | 18.03 | 24.91 | 23.36          |
| CRTM 3 - 2N | 3/16           | 4.76  | 1/8         | 3.04      | 1/2               | 12.70 | 1/2   | 12.70 | 13.71 | 16.00 | 17.78 | 24.38 | 17.78          |
| CRTM 4 - 2N | 1/4            | 6.35  | 1/8         | 4.82      | 1/2               | 12.70 | 9/16  | 14.28 | 15.24 | 17.78 | 19.55 | 26.92 | 18.79          |
| CRTM 4 - 4N | 1/4            | 6.35  | 1/4         | 4.82      | 1/2               | 12.70 | 9/16  | 14.28 | 15.24 | 17.78 | 19.55 | 26.92 | 23.87          |
| CRTM 5 - 2N | 5/16           | 7.93  | 1/8         | 4.82      | 9/16              | 14.28 | 5/8   | 15.87 | 16.25 | 18.54 | 22.35 | 29.71 | 20.82          |
| CRTM 6 - 4N | 3/8            | 9.52  | 1/4         | 7.11      | 5/8               | 15.87 | 11/16 | 17.46 | 16.75 | 19.30 | 23.11 | 30.48 | 25.40          |
| CRTM 6 - 6N | 3/8            | 9.52  | 3/8         | 7.11      | 11/16             | 17.46 | 11/16 | 17.46 | 16.76 | 19.30 | 23.87 | 31.24 | 26.20          |
| CRTM 8 - 6N | 1/2            | 12.70 | 3/8         | 9.50      | 13/16             | 20.63 | 7/8   | 22.22 | 22.86 | 21.84 | 25.90 | 36.06 | 28.19          |
| CRTM 8 - 8N | 1/2            | 12.70 | 1/2         | 10.41     | 13/16             | 20.63 | 7/8   | 22.22 | 22.86 | 21.84 | 25.90 | 36.06 | 33.02          |
| CRTM10 - 8N | 5/8            | 15.87 | 1/2         | 11.93     | 15/16             | 23.80 | 1     | 25.40 | 24.38 | 21.84 | 27.94 | 38.10 | 35.05          |
| CRTM12- 12N | 3/4            | 19.05 | 3/4         | 15.74     | 1-1/16            | 26.98 | 1-1/8 | 28.57 | 24.38 | 21.84 | 29.71 | 39.87 | 36.83          |

\* ISO Tapered Threads are available upon request.

### Connects Metric Tube To Female ISO Tapered Thread

| Part No.       | Tube<br>O.D.<br>D | T*<br>R(PT) | d<br>Min. | Width across flat |    | A    | B    | ℓ    | L    | L <sub>1</sub> |
|----------------|-------------------|-------------|-----------|-------------------|----|------|------|------|------|----------------|
|                |                   |             |           | h                 | H  |      |      |      |      |                |
| CRTM 3M - 2R   | 3                 | 1/8         | 2.4       | 12.7              | 12 | 12.9 | 15.3 | 17.0 | 23.6 | 17.8           |
| CRTM 3M - 4R   | 3                 | 1/4         | 2.4       | 12.7              | 12 | 12.9 | 15.3 | 18.0 | 24.6 | 23.4           |
| CRTM 4M - 2R   | 4                 | 1/8         | 2.4       | 12.7              | 12 | 13.7 | 16.1 | 18.8 | 25.4 | 18.8           |
| CRTM 6M - 2R   | 6                 | 1/8         | 4.8       | 12.7              | 14 | 15.3 | 17.7 | 19.6 | 27.0 | 18.8           |
| CRTM 6M - 4R   | 6                 | 1/4         | 4.8       | 12.7              | 14 | 15.3 | 17.7 | 19.6 | 27.0 | 23.4           |
| CRTM 8M - 2R   | 8                 | 1/8         | 4.8       | 14.3              | 16 | 16.2 | 18.6 | 21.3 | 28.8 | 19.8           |
| CRTM 8M - 4R   | 8                 | 1/4         | 6.3       | 14.3              | 16 | 16.2 | 18.6 | 21.3 | 28.8 | 24.4           |
| CRTM 10M - 4R  | 10                | 1/4         | 7.1       | 17.5              | 19 | 17.2 | 19.5 | 23.9 | 31.5 | 28.2           |
| CRTM 10M - 6R  | 10                | 3/8         | 7.9       | 17.5              | 19 | 17.2 | 19.5 | 23.9 | 31.5 | 28.2           |
| CRTM 12M - 4R  | 12                | 1/4         | 7.1       | 20.6              | 22 | 22.8 | 22.0 | 25.9 | 36.0 | 28.2           |
| CRTM 12M - 6R  | 12                | 3/8         | 9.5       | 20.6              | 22 | 22.8 | 22.0 | 25.9 | 36.0 | 28.2           |
| CRTM 12M - 8R  | 12                | 1/2         | 9.5       | 20.6              | 22 | 22.8 | 22.0 | 25.9 | 36.0 | 33.0           |
| CRTM 16M - 6R  | 16                | 3/8         | 9.5       | 23.8              | 25 | 24.4 | 22.0 | 27.9 | 38.0 | 30.2           |
| CRTM 16M - 8R  | 16                | 1/2         | 11.9      | 23.8              | 25 | 24.4 | 22.0 | 27.9 | 38.0 | 35.1           |
| CRTM 20M - 12R | 20                | 3/4         | 15.9      | 30.0              | 32 | 26.0 | 22.0 | 34.5 | 44.6 | 41.7           |

\* NPT Threads are available upon request.

All dimensions are in millimeters unless otherwise specified. Dimensions are for reference only, subject to change.