

Hy-Lok Two Ferrule Tube Fittings

Swivel Elbow New CSL

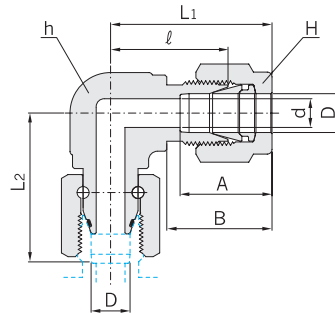

Connects Fractional Tubes

Part No.	Tube O.D. D		d Min.	Width across flat				A	B	ℓ	L ₁	L ₂
				h		H						
				in	mm	in	mm					
CSL - 4	1/4	6.35	4.82	1/2	12.70	9/16	14.28	15.24	17.78	19.55	26.92	25.08
CSL - 6	3/8	9.52	7.11	5/8	15.87	11/16	17.46	16.76	19.30	23.11	30.48	28.48
CSL - 8	1/2	12.70	10.41	13/16	20.63	7/8	22.22	22.86	21.84	25.90	36.06	36.91
CSL - 10	5/8	15.87	12.70	15/16	23.80	1	25.40	24.38	21.84	28.70	38.80	41.34
CSL - 12	3/4	19.05	15.74	1-1/16	26.98	1-1/8	28.57	24.38	21.84	29.71	39.87	42.45
CSL - 14	7/8	22.22	18.28	1-3/16	30.00	1-1/4	31.75	25.90	21.84	34.54	44.70	49.30
CSL - 16	1	25.40	22.35	1-3/8	34.92	1-1/2	38.10	31.24	26.41	36.83	49.02	53.11

Connects Metric Tubes

Part No.	Tube O.D. D	d Min.	Width across flat		A	B	ℓ	L ₁	L ₂
			h	H					
CSL - 6M	6	4.8	12.7	14	15.3	17.7	19.6	27.0	25.07
CSL - 8M	8	6.3	14.3	16	16.2	18.6	21.3	28.8	26.81
CSL - 10M	10	7.9	17.5	19	17.2	19.5	23.9	31.5	30.11
CSL - 12M	12	9.5	20.6	22	22.8	22.0	25.9	36.0	36.91
CSL - 15M	15	11.9	23.8	25	24.4	22.0	28.7	38.8	41.31
CSL - 16M	16	12.7	23.8	25	24.4	22.0	28.7	38.8	41.34
CSL - 18M	18	15.1	27.0	30	24.4	22.0	29.7	39.8	42.38
CSL - 20M	20	15.9	30.0	32	26.0	22.0	32.5	42.6	47.11
CSL - 22M	22	18.3	30.0	32	26.0	22.0	32.5	42.6	49.16
CSL - 25M	25	21.8	34.9	38	31.3	26.5	36.8	49.1	53.79

Assembly instruction for swivel fitting with O-Ring

1.0 Oil O-ring.

Tighten the nut 1/4 turn with a wrench beyond application of increased effort is required.

Hold fitting body firmly by means of wrench

1.1 In difficult mounting situation on large tube sizes, final assembly must be completed in vice with the fitting body.

Caution!

Any deviating of tightening turns reduces the nominal pressure and the service life of the fitting, and may cause leakages or slip of the fitting.

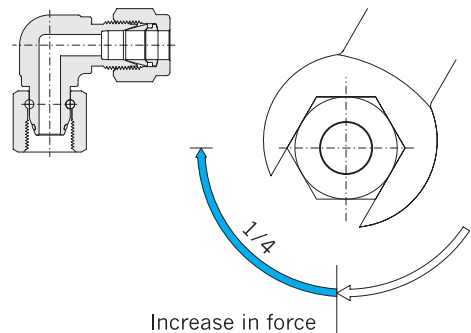

All dimensions are in millimeters unless otherwise specified. Dimensions are for reference only, subject to change.