

Hy-Lok Two Ferrule Tube Fittings

Features & Application

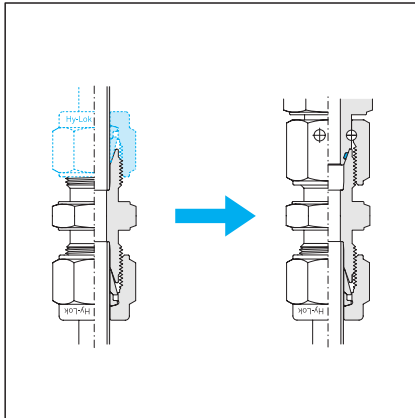

1. Features

Assembly is easy and usability is superb than Hy-Lok Reducer Type tube fitting(CR) assuring the superior sealing by operating O-Ring. Also O-Ring is connected to Body nipple machined by 40° cone Ends and form O-Ring Seal by facing with Body 40° Taper. So Body Nipple should be assembled by this kinds of fact. It should be easy for storage and handling.

2. Application

If the place where we assemble is quite narrow, its assembly could be easy and It should not only be applied for Metric and Imperial(Inch) Size but also apply a different type of shape(Union, Elbow, Tee).

Since it has a superb sealing feature, It should be satisfied with various customer by applying different territory which need safety like a Gas Line.

Swivel Reducing Adapter **CSRA**

New

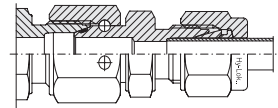
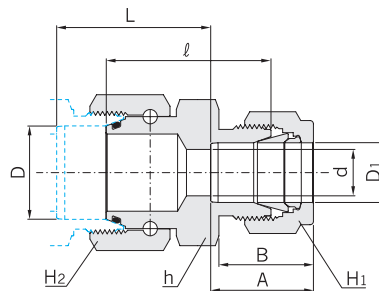

Connects Fractional Tubes

Part No.	Tube O.D.		Tube O.D. D ₁	d Min.	Width across flat						A	B	l	L	
	D				h		H ₁		H ₂						
	in	mm			in	mm	in	mm	in	mm					
CSRA 4- 1	1/4	6.35	1/16	1.58	1.27	7/16	11.11	9/16	14.28	5/16	7.93	8.63	10.92	23.2	23.15
CSRA 4- 2	1/4	6.35	1/8	3.17	2.30	7/16	11.11	9/16	14.28	7/16	11.11	12.70	15.24	24.7	23.15
CSRA 4- 3	1/4	9.52	3/16	4.76	3.00	7/16	11.11	9/16	14.28	1/2	12.70	13.71	16.00	25.6	23.25
CSRA 4- 4	1/4	6.35	1/4	6.35	4.82	1/2	12.70	9/16	14.28	9/16	14.28	15.24	17.78	26.7	23.50
CSRA 4- 6	1/4	6.35	3/8	9.52	4.82	5/8	15.87	9/16	14.28	11/16	17.46	16.76	19.30	29.2	24.45
CSRA 4- 8	1/4	6.35	1/2	12.70	4.82	13/16	20.64	9/16	14.28	7/8	22.22	22.86	21.84	29.9	22.00
CSRA 6- 2	3/8	6.35	1/8	3.17	2.30	1/2	12.70	11/16	17.46	7/16	11.11	12.70	15.24	25.1	25.02
CSRA 6- 4	3/8	9.52	1/4	6.35	4.82	1/2	12.70	11/16	17.46	9/16	14.28	15.24	17.78	26.7	24.97
CSRA 6- 8	3/8	9.52	1/2	12.70	7.11	13/16	20.64	11/16	17.46	7/8	22.22	22.86	21.84	29.9	23.47
CSRA 8- 2	1/2	12.70	1/8	3.17	2.30	11/16	17.40	7/8	22.22	7/16	11.11	12.70	15.24	29.5	31.58
CSRA 8- 4	1/2	12.70	1/4	6.35	4.82	11/16	17.40	7/8	22.22	9/16	14.28	15.24	17.78	31.1	31.53
CSRA 8- 6	1/2	12.70	3/8	9.52	7.11	11/16	17.40	7/8	22.22	11/16	17.46	16.76	19.30	32.7	31.58
CSRA 8- 8	1/2	12.70	1/2	12.70	10.41	13/16	20.64	7/8	22.22	7/8	22.22	22.86	21.84	33.4	29.13
CSRA 8-12	1/2	12.70	3/4	19.05	10.41	1 1/16	26.98	7/8	22.22	1-1/8	28.57	24.38	21.84	35.9	30.03
CSRA 10- 6	5/8	15.87	3/8	9.52	7.11	13/16	20.64	1	25.40	11/16	17.46	16.76	19.30	33.5	33.94
CSRA 10- 8	5/8	15.87	1/2	12.70	10.41	13/16	20.64	1	25.40	7/8	22.22	22.86	21.84	33.5	30.79
CSRA 12- 4	3/4	19.05	1/4	6.35	4.82	15/16	23.80	1-1/8	28.57	9/16	14.28	15.24	17.78	32.8	34.90
CSRA 12- 6	3/4	19.05	3/8	9.52	7.11	15/16	23.80	1-1/8	28.57	11/16	17.46	16.76	19.30	34.4	34.95
CSRA 12- 8	3/4	19.05	1/2	12.70	10.41	15/16	23.80	1-1/8	28.57	7/8	22.22	22.86	21.84	34.4	31.80
CSRA 12-10	3/4	19.05	5/8	15.87	12.70	15/16	23.80	1-1/8	28.57	1	25.40	24.38	21.84	34.5	30.30
CSRA 12-16	3/4	19.05	1	25.40	15.74	1 3/8	34.92	1-1/8	28.57	1-1/2	38.10	31.24	26.41	40.7	31.75
CSRA 14-10	7/8	22.22	5/8	15.87	12.70	1 1/8	28.50	1-1/4	31.75	1	25.40	24.38	21.84	37.3	34.75
CSRA 16- 8	1	25.40	1/2	12.70	10.41	1 1/4	31.70	1-1/2	38.10	7/8	22.22	22.86	21.84	40.8	40.66
CSRA 16-10	1	25.40	5/8	15.87	12.70	1 1/4	31.70	1-1/2	38.10	1	25.40	24.38	21.84	40.9	39.16
CSRA 16-12	1	25.40	3/4	19.05	15.74	1 1/4	31.70	1-1/2	38.10	1-1/8	28.57	24.38	21.84	40.9	39.16

All dimensions are in millimeters unless otherwise specified. Dimensions are for reference only, subject to change.



Swivel Reducing Adapter **New**
CSRA

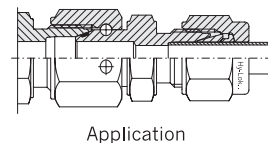
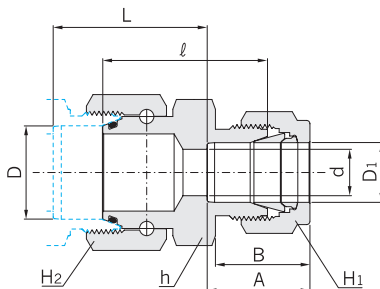

Connects Metric Tubes

Part No.	Tube O.D.		d Min.	Width across flat			A	B	l	L
	D	D ₁		h	H ₁	H ₂				
CSRA 6M - 3M	6	3	2.4	12.0	12	14	12.9	15.3	24.7	23.09
CSRA 6M - 4M	6	4	2.4	12.0	12	14	13.7	16.1	25.5	23.14
CSRA 6M - 8M	6	8	4.8	14.0	16	14	16.2	18.6	27.5	23.54
CSRA 6M - 10M	6	10	4.8	17.0	19	14	17.2	19.5	29.3	24.59
CSRA 6M - 12M	6	12	4.8	22.0	22	14	22.8	22.0	30.1	22.19
CSRA 8M - 6M	8	6	4.8	12.0	14	16	15.3	17.7	26.3	23.96
CSRA 8M - 12M	8	12	6.3	22.0	22	16	22.8	22.0	30.1	23.06
CSRA10M - 6M	10	6	4.8	15.8	14	19	15.3	17.7	28.6	26.86
CSRA10M - 8M	10	8	6.3	15.8	16	19	16.2	18.6	29.4	26.91
CSRA10M - 12M	10	12	7.9	22.0	22	19	22.8	22.0	31.0	24.56
CSRA12M - 6M	12	6	4.8	19.0	14	22	15.3	17.7	31.4	31.83
CSRA12M - 8M	12	8	6.3	19.0	16	22	16.2	18.6	32.4	32.08
CSRA12M - 10M	12	10	7.9	19.0	19	22	17.2	19.5	33.2	32.13
CSRA12M - 16M	12	16	9.5	23.8	25	22	24.4	22.0	34.4	28.53
CSRA12M - 18M	12	18	9.5	27.0	30	22	24.4	22.0	35.9	30.03
CSRA15M - 10M	15	10	7.9	22.0	19	25	17.2	19.5	33.7	34.16
CSRA15M - 12M	15	12	9.5	22.0	22	25	22.8	22.0	33.7	30.96
CSRA16M - 10M	16	10	7.9	22.0	19	25	17.2	19.5	33.7	34.19
CSRA16M - 12M	16	12	9.5	22.0	22	25	22.8	22.0	33.7	30.99
CSRA16M - 18M	16	18	12.7	27.0	30	25	24.4	22.0	36.0	31.69
CSRA16M - 20M	16	20	12.7	30.0	32	25	26.0	22.0	37.5	33.19
CSRA18M - 10M	18	10	7.9	23.8	19	30	17.2	19.5	34.5	35.03
CSRA18M - 12M	18	12	9.5	23.8	22	30	22.8	22.0	34.4	31.78
CSRA18M - 20M	18	20	15.1	30.0	32	30	26.0	22.0	37.5	31.63
CSRA18M - 22M	18	22	15.1	30.0	32	30	26.0	22.0	37.5	31.63
CSRA18M - 25M	18	25	15.1	35.0	38	30	31.3	26.5	40.6	31.48
CSRA20M - 12M	20	12	9.5	27.0	22	32	22.8	22.0	36.4	35.31
CSRA20M - 18M	20	18	15.1	27.0	30	32	24.4	22.0	36.4	33.66
CSRA20M - 22M	20	22	15.9	30.0	32	32	26.0	22.0	37.9	33.56
CSRA20M - 25M	20	25	15.9	35.0	38	32	31.3	26.5	41.0	33.41
CSRA22M - 12M	22	12	9.5	27.0	22	32	22.8	22.0	36.4	35.36
CSRA22M - 18M	22	18	15.1	27.0	30	32	24.4	22.0	36.4	33.71
CSRA22M - 20M	22	20	15.9	30.0	32	32	26.0	22.0	37.9	33.61
CSRA25M - 12M	25	12	9.5	32.0	22	38	22.8	22.0	41.1	41.69
CSRA25M - 18M	25	18	15.1	32.0	30	38	24.4	22.0	40.9	39.89
CSRA25M - 20M	25	20	15.9	32.0	32	38	26.0	22.0	41.1	38.49
CSRA25M - 22M	25	22	18.3	32.0	32	38	26.0	22.0	41.1	38.49

All dimensions are in millimeters unless otherwise specified. Dimensions are for reference only, subject to change.