

# Tube Fittings for DIN 2353 & ISO 8434 part1

## Welding Connector DAS

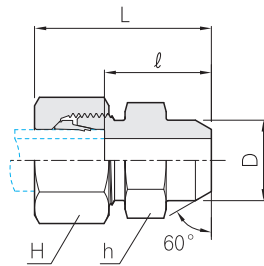

Series	Part No.	Tube O.D.	D	H	h	L	l	PN(bar)	
								Steel	SS316
L	DAS - 06L	6	10	14	12	29	14.0	315	315
	DAS - 08L	8	12	17	14	31	16.0	315	315
	DAS - 10L	10	14	19	17	33	18.0	315	315
	DAS - 12L	12	16	22	19	33	18.0	315	315
	DAS - 15L	15	19	27	22	37	22.0	315	315
	DAS - 18L	18	22	32	27	40	23.5	315	315
	DAS - 22L	22	27	36	32	45	28.5	160	160
	DAS - 28L	28	32	41	41	47	30.5	160	160
	DAS - 35L	35	40	50	46	54	32.5	160	160
	DAS - 42L	42	46	60	55	58	35.0	160	160
S	DAS - 06S	6	11	17	14	34	19.0	630	630
	DAS - 08S	8	13	19	17	36	21.0	630	630
	DAS - 10S	10	15	22	19	39	22.5	630	630
	DAS - 12S	12	17	24	22	41	24.5	630	630
	DAS - 14S	14	19	27	24	45	27.0	630	630
	DAS - 16S	16	21	30	27	45	26.5	400	400
	DAS - 20S	20	26	36	32	51	29.5	400	400
	DAS - 25S	25	31	46	41	56	32.0	400	400
	DAS - 30S	30	36	50	46	62	35.5	400	400
	DAS - 38S	38	44	60	55	69	38.0	315	315

## Welding Connector with DAK DASK

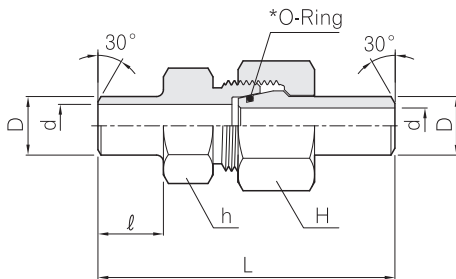

Series	Part No.	Tube O.D.	D	d	H	h	L	l	PN(bar)	
									Steel	SS316
S	DASK 10 x 1.0	10	8	22	19	58.0	10.0	249	242	
	DASK 10 x 1.5	10	7	22	19	58.0	10.0	358	349	
	DASK 10 x 2.0	10	6	22	19	58.0	10.0	460	447	
	DASK 12 x 1.5	12	9	24	22	65.0	15.0	305	297	
	DASK 12 x 2.0	12	8	24	22	65.0	15.0	393	383	
	DASK 12 x 2.5	12	7	24	22	65.0	15.0	476	463	
	DASK 16 x 1.5	16	13	30	27	74.5	16.5	234	228	
	DASK 16 x 2.0	16	12	30	27	74.5	16.5	305	297	
	DASK 16 x 2.5	16	11	30	27	74.5	16.5	372	362	
	DASK 16 x 3.0	16	10	30	27	74.5	16.5	400	400	
	DASK 20 x 2.0	20	16	36	32	84.0	19.0	249	242	
	DASK 20 x 2.5	20	15	36	32	84.0	19.0	305	297	
	DASK 20 x 3.0	20	14	36	32	84.0	19.0	358	349	
	DASK 20 x 4.0	20	12	36	32	84.0	19.0	400	400	
	DASK 25 x 3.0	25	19	46	41	94.5	19.5	294	286	
	DASK 25 x 4.0	25	17	46	41	94.5	19.5	379	369	
	DASK 25 x 5.0	25	15	46	41	94.5	19.5	400	400	
	DASK 30 x 3.0	30	24	50	46	102.0	23.0	249	242	
	DASK 30 x 4.0	30	22	50	46	102.0	23.0	323	314	
	DASK 30 x 5.0	30	20	50	46	102.0	23.0	393	383	
	DASK 30 x 6.0	30	18	50	46	102.0	23.0	400	400	
	DASK 38 x 4.0	38	30	60	55	111.0	23.0	261	254	
	DASK 38 x 5.0	38	28	60	55	111.0	23.0	315	311	
	DASK 38 x 6.0	38	26	60	55	111.0	23.0	315	315	
	DASK 38 x 7.0	38	24	60	55	111.0	23.0	315	315	

All dimensions are in millimeters for reference only, subject to change.

\* The standard O-Ring material is NBR(e.g. Perbunan®) however FPM(e.g. Viton®) is also available on request (See Page 3).  
Max. Pressure ratings are based on carbon steel, and the pressure rating of the stainless steel refers to page 5.