

Tube Fittings for DIN 2353 & ISO 8434 part1

Male Connector (BSP Paralled)

DMC-G

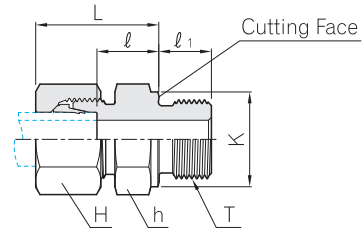

Form B stud end

Series	Part No.	Tube O.D.	H	h	K	L	l	l ₁	T R(PT), G(PF)	PN(bar)		
										C.Steel	SS316	BRASS
L	DMC 06L - 01G	6	14	14	14	23.0	8.5	8	PF 1/8	315	315	200
	DMC 06L - 02G	6	14	19	18	25.0	10.0	12	PF 1/4	315	315	200
	DMC 06L - 03G	6	14	22	22	26.0	11.5	12	PF 3/8	315	315	200
	DMC 06L - 04G	6	14	27	26	27.0	12.0	14	PF 1/2	315	315	
	DMC 08L - 01G	8	17	14	14	23.0	8.5	8	PF 1/8	315	315	
	DMC 08L - 02G	8	17	19	18	25.0	10.0	12	PF 1/4	315	315	200
	DMC 08L - 03G	8	17	22	22	26.0	11.5	12	PF 3/8	315	315	200
	DMC 08L - 04G	8	17	27	26	27.0	12.0	14	PF 1/2	315	315	200
	DMC 10L - 02G	10	19	19	18	26.0	11.0	12	PF 1/4	315	315	200
	DMC 10L - 03G	10	19	22	22	27.0	12.5	12	PF 3/8	315	315	200
	DMC 10L - 04G	10	19	27	26	28.0	13.0	14	PF 1/2	315	315	200
	DMC 12L - 02G	12	22	19	18	27.0	12.0	12	PF 1/4	315	315	200
	DMC 12L - 03G	12	22	22	22	27.0	12.5	12	PF 3/8	315	315	200
	DMC 12L - 04G	12	22	27	26	28.0	13.0	14	PF 1/2	315	315	200
	DMC 12L - 06G	12	22	32	32	29.0	14.0	16	PF 3/4	315	315	
	DMC 15L - 03G	15	27	24	22	29.0	13.5	12	PF 3/8	250	250	160
	DMC 15L - 04G	15	27	27	26	29.0	14.0	14	PF 1/2	250	250	160
	DMC 15L - 06G	15	27	32	32	30.0	15.0	16	PF 3/4	250	250	
	DMC 18L - 03G	18	32	27	22	29.5	14.0	12	PF 3/8	250	250	
	DMC 18L - 04G	18	32	27	26	31.0	14.5	14	PF 1/2	250	250	160
	DMC 18L - 06G	18	32	32	32	30.0	14.5	16	PF 3/4	250	250	
	DMC 22L - 04G	22	36	32	26	33.0	16.5	14	PF 1/2	160	160	100
	DMC 22L - 06G	22	36	32	32	33.0	16.5	16	PF 3/4	160	160	100
	DMC 28L - 06G	28	41	41	32	34.0	17.5	16	PF 3/4	160	160	
DMC 28L - 08G	28	41	41	39	34.0	17.5	18	PF 1	160	160	100	
DMC 35L - 08G	35	50	46	39	39.0	17.5	18	PF 1	160	160		
DMC 35L - 10G	35	50	50	49	39.0	17.5	20	PF 1 1/4	160	160	100	
DMC 42L - 12G	42	60	55	55	42.0	19.0	22	PF 1 1/2	160	160	100	
S	DMC 06S - 02G	6	17	19	18	28.0	13.0	12	PF 1/4	400	400	250
	DMC 06S - 04G	6	17	27	26	33.0	18.0	14	PF 1/2	400	400	
	DMC 08S - 02G	8	19	19	18	30.0	15.0	12	PF 1/4	400	400	250
	DMC 08S - 03G	8	19	22	22	30.0	15.5	12	PF 3/8	400	400	
	DMC 10S - 02G	10	22	19	18	31.0	14.5	12	PF 1/4	400	400	
	DMC 10S - 03G	10	22	22	22	31.0	15.0	12	PF 3/5	400	400	250
	DMC 10S - 04G	10	22	27	26	34.0	17.5	14	PF 1/2	400	400	
	DMC 12S - 02G	12	24	22	18	33.0	16.5	12	PF 1/4	400	400	
	DMC 12S - 03G	12	24	22	22	33.0	17.0	12	PF 3/8	400	400	250
	DMC 12S - 04G	12	24	27	26	34.0	17.5	14	PF 1/2	400	400	
	DMC 14S - 03G	14	27	24	22	36.0	18.5	12	PF 3/8	400	400	
	DMC 14S - 04G	14	27	27	26	37.0	19.0	14	PF 1/2	400	400	250
	DMC 16S - 03G	16	30	27	22	36.0	18.0	12	PF 3/8	400	400	
	DMC 16S - 04G	16	30	27	26	37.0	18.5	14	PF 1/2	400	400	250
	DMC 16S - 06G	16	30	32	32	39.0	20.5	16	PF 3/4	400	400	
	DMC 20S - 04G	20	36	32	26	42.0	20.5	14	PF 1/2	400	400	
	DMC 20S - 06G	20	36	32	32	42.0	20.5	16	PF 3/4	400	400	250
	DMC 25S - 06G	25	46	41	32	47.0	23.0	16	PF 3/4	250	250	160
	DMC 25S - 08G	25	46	41	39	47.0	23.0	18	PF 1	250	250	
	DMC 30S - 08G	30	50	46	39	50.0	23.5	18	PF 1	160	160	
	DMC 30S - 10G	30	50	50	49	50.0	23.5	20	PF 1 1/4	160	160	100
	DMC 38S - 10G	38	60	55	49	57.0	26.0	20	PF 1 1/4	160	160	
	DMC 38S - 12G	38	60	55	55	57.0	26.0	22	PF 1 1/2	160	160	100

Dimensions are given for approximate length with tightened nut. All dimensions are in millimeters for reference only, subject to change.