

Pipe Fittings

Street Elbows SLC

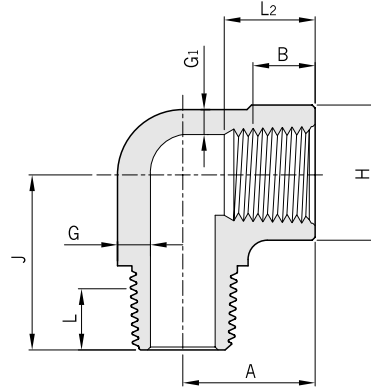

ASME B16.11

Class Designation of Fittings	Nom. Pipe Size	DN	Center-to-Female End Street Ells A ⁽¹⁾	Center-to-Male End Street Ells J	Outside Diameter of Band H ⁽²⁾	Min. Wall Thickness G ₁	Min. Wall Thickness G ⁽³⁾	Min. Length Internal Thread ⁽⁴⁾		Min. Length Male Thread L
								B	L ₂	
3000	1/8	6	19	25	19	3.18	2.74	6.4	6.7	10
	1/4	8	22	32	25	3.30	3.22	8.1	10.2	11
	3/8	10	25	38	32	3.51	3.50	9.1	10.4	13
	1/2	15	28	41	38	4.09	4.16	10.9	13.6	14
	3/4	20	35	48	44	4.32	4.88	12.7	13.9	16
	1	25	44	57	51	4.98	5.56	14.7	17.3	19
	1 1/4	32	51	66	62	5.28	5.56	17.0	18.0	21
	1 1/2	40	54	71	70	5.56	6.25	17.8	18.4	21
2	50	64	84	84	84	7.14	7.64	19.0	19.2	22

- Note :** (1) Dimension A listed on page 21 for the appropriate fitting size may also be used at the option of the manufacturer.
 (2) Dimension H listed on page 21 for the appropriate fitting size may also be used at the option of the manufacturer.
 (3) Wall thickness before threading.
 (4) Dimension B is minimum length of perfect thread. The length of useful thread (B plus threads with fully formed roots and flat crests) shall not be less than L₂ (effective length of external thread) required by American National Standard for pipe threads (ASME B1.20.1)

All dimensions are in millimeters.

Street Elbows
SLC

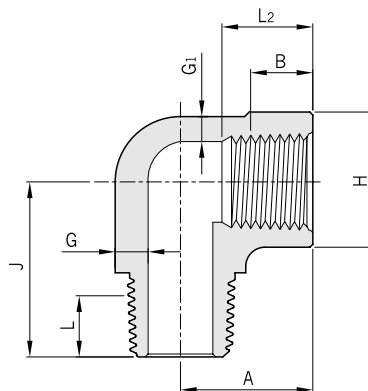

ASME B16.11

Class Designation of Fittings	Nom. Pipe Size	DN	Center-to-Female End Street Ells A ⁽¹⁾	Center-to-Male End Street Ells J	Outside Diameter of Band H ⁽²⁾	Min. Wall Thickness G ₁	Min. Wall Thickness G ⁽³⁾	Min. Length Internal Thread ⁽⁴⁾		Min. Length Male Thread L
								B	L ₂	
6000	1/8	6	22	32	25	5.08	4.22	6.4	6.7	10
	1/4	8	25	38	32	5.66	5.28	8.1	10.2	11
	3/8	10	28	41	38	6.98	5.59	9.1	10.4	13
	1/2	15	35	48	44	8.15	6.53	10.9	13.6	14
	3/4	20	44	57	51	8.53	6.86	12.7	13.9	16
	1	25	51	66	62	9.93	7.95	14.7	17.3	19
	1 1/4	32	54	71	70	10.59	8.48	17.0	18.0	21
	1 1/2	40	64	84	84	11.07	8.89	17.8	18.4	21
2	50	83	105	102	12.09	9.70	19.0	19.2	22	

- Note :** (1) Dimension A listed on page 22 for the appropriate fitting size may also be used at the option of the manufacturer.
 (2) Dimension H listed on page 22 for the appropriate fitting size may also be used at the option of the manufacturer.
 (3) Wall thickness before threading.
 (4) Dimension B is minimum length of perfect thread. The length of useful thread (B plus threads with fully formed roots and flat crests) shall not be less than L₂ (effective length of external thread) required by American National Standard for pipe threads (ASME B1.20.1)

All dimensions are in millimeters.