



Safety Pattern / Solid Front
pressure gauges

IMP5 series



Ham-Let Industrial Mechanical
Pressure gauges



IMPS series data sheet:

General:

The Industrial, S-Safety Pattern / Solid Front pressure gauges series is a heavy duty pressure gauge with special case and laminated safety glass window delivering a safer usage for the end system user while maintaining the long usability and durability for indoor, outdoor and harsh surroundings industrial, instrumentation and process applications.

The safety pattern / Solid Front case has a break-proof solid front (firm partition between the pressure element and the window) and a pressure relief back (blow-out back).

The S series gauges are marked with the © symbol on the dial. The S series pressure gauge is a bourdon tube mechanical device, Case sizes 63, 100, 160mm (2½", 4", 6") suitable for vacuum to pressure up to 1000bar (15,000psi).

Features:

- All stainless steel case and wetted parts.
- Bayonet ring and adjustable pointer for easy adjustment
- Break-proof solid front case with blow-out back.
- Safety laminated glass front.
- Case is filled or fillable dry.
- Case Protection: IP 65.
- Safety Category (EN 837-1) S3.
- **Measuring Ranges**
 - Vacuum: 30" Hg Vac. to 0 psi (-1 to 0 bar)
 - Compound: 30" Hg Vac. through 0 to 300 psi (-1 through 0 to 15 bar)
 - Pressure: 0 to 15,000 psi (0 to 1,000 bar)

Materials of construction



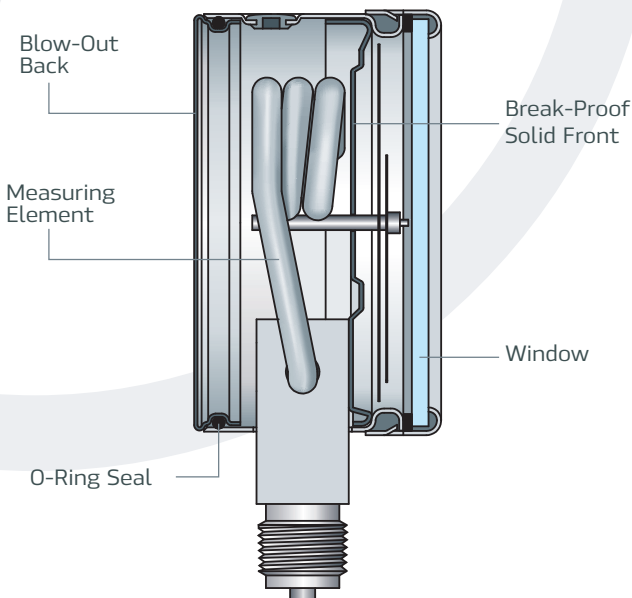



Part		Material
Wetted Parts:	Process Connection	SS 316L
	Bourdon Tube	
Case		SS 304L
Window		Laminated safety glass
Movement		Stainless Steel
Dial		Aluminum (black figures, white background)
Pointer		Aluminum (black)



Ham-Let IMP gauges S Series



Technical Data S Series

Case Size		63mm (2½")	100mm (4")	160mm (6")
Accuracy	Up to 6,000psi (400 bar)	±1.6% of span EN 837-1 Class 1.6 ASME B40.1 Grade B	±1.0% of span EN 837-1 Class 1.0 ASME B40.1 Grade 1A	±1.0% of span EN 837-1 Class 1.0 ASME B40.1 Grade 1A
	10,000psi (600bar) and above (2)	±2.5% of span EN 837-1 Class 2.5 ASME B40.1 Grade c	±1.0% of span EN 837-1 Class 1.0 ASME B40.1 Grade 1A	±1.0% of span EN 837-1 Class 1.0 ASME B40.1 Grade 1A
Case Configurations	Process connection position	 (3)	 (3)	
	Mounting device (Optional)			
Process Connection	½", 12mm Tube adapter		+	
	¾", 10mm Tube adapter	+		
	¼", 6mm Tube adapter	+		
	½" BSP-P/NPT		+	+
	¼" BSP-P/NPT	+	+	+
	1/8" BSP-P/NPT	+		
	M20x1.5		+	+
M12x1.5	+	+	+	
Blow-Out Device	Blow-out back	+	+	+
Case Ventilation	Screw with ventilation bore	+	+	+
	Internal pressure compensation by pressure equalizing membrane	+	+	
Weight (1) Pound (Kg.)	Unfilled	0.39 (0.18)	1.40 (0.65)	3.30 (1.50)
	Filled	0.55 (0.25)	2.20 (1.00)	6.5 (2.95)

(1) Approx. without mounting device
 (2) See Maximal pressure per connection type, page 6
 (3) Lower back connection available only for filled or fillable option



Ham-Let IMP gauges **S** Series

Configuration And Mounting Dimensions

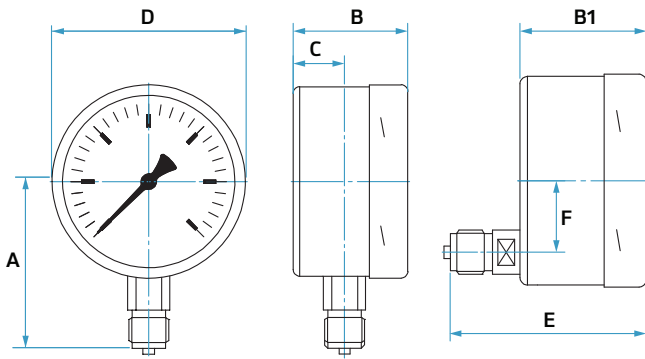

Lower Mount

Lower Back Mount

Case Size		A		B		B1		C		D		E		F	
mm	inch	mm	inch	mm	inch	mm	inch	mm	inch	mm	inch	mm	inch	mm	inch
63	2 1/2	54	2.13	41	1.61	41	1.61	18	0.71	64	2.52	63	2.48	18	0.71
100	4	87	3.43	60	2.36	60	2.36	27	1.06	101	3.98	93	3.66	34	1.34
160	6	115	4.53	78	3.07	78	3.07	40	1.57	161	6.34	-	-	-	-

Back Flange Mounting

Front Flange Mounting

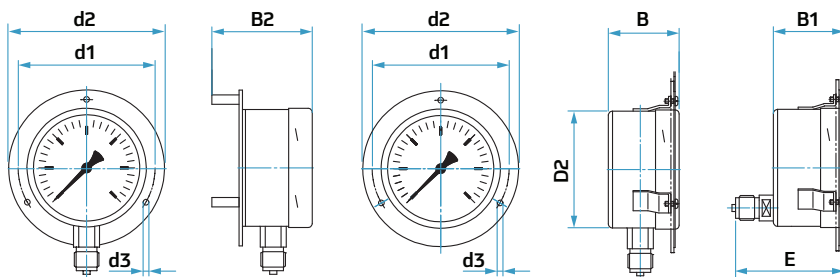

Case Size		B2		d1		d2		d3	
mm	inch	mm	inch	mm	inch	mm	inch	mm	inch
63	2 1/2	61	2.4	75	2.95	85	3.35	3.6	0.14
100	4	85	3.35	116	4.57	132	5.2	4.8	0.19
160	6	108	4.25	178	7.01	196	7.72	5.8	0.23