

Pilot pressure regulator ST 2000



Pilot pressure regulator ST 2000

Dimensions and connections

Bore template for panel mounting

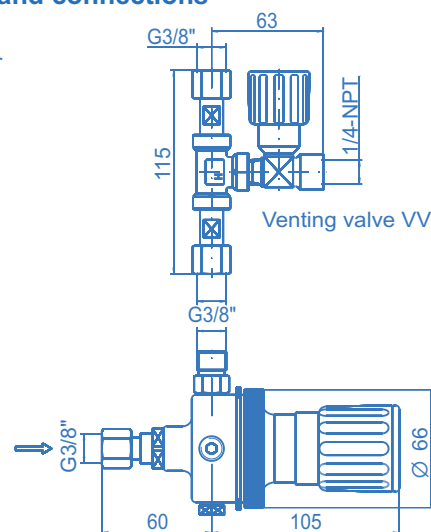
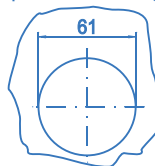

Product features

- Pilot pressure regulator for dome loaded pressure regulators controlled with process or a separate gas.
- For U12, U22 and U42 (control with a separate gas: upon request)
- Single-stage with high control accuracy
- Operation reliability by central filter in pressure regulator
- Dust protected adjusting spindle
- Central filter in the pressure regulator
- Outlet pressure limitation by special adjustment
- For panel mounting
- Ergonomically designed
- Approved for use with oxygen

Technical data

Type	single-stage
Inlet pressure P_1	max. 40 bar
Outlet pressure P_2	1,5 - 30 bar

Materials

Body:	brass
Bonnet:	brass
Diaphragm:	EPDM
Valve seat:	PA

In- and outlets

Inlet:	G 3/8"- female
Outlet:	G 3/8"- male*

Temperature range -30°C to +60°C

Leak rate $<10^{-4}$ mbar l/s He

Weight approx. 1,6 kg

*G 1/2"- male: upon request

Ordering information:
Pressure regulator ST 2000

ST 2000 - 40 - 1,5 - VV

Inlet pressure P_1

Outlet pressure P_2 part no.

1,5	- 1,5 bar*	717.05640
4	- 4 bar*	717.05641
10	- 10 bar	717.05642
20	- 20 bar	717.05643
30	- 30 bar	717.05644

Venting valve

VV	- with venting valve
0	- without venting valve

* For outlet pressures from 1.5 bar to 4 bar a venting valve is necessary to relief the control pressure.